

CONSTRUCTION PHASE 1 – Feb 2023 TO MAY 2024 (16 MONTHS)

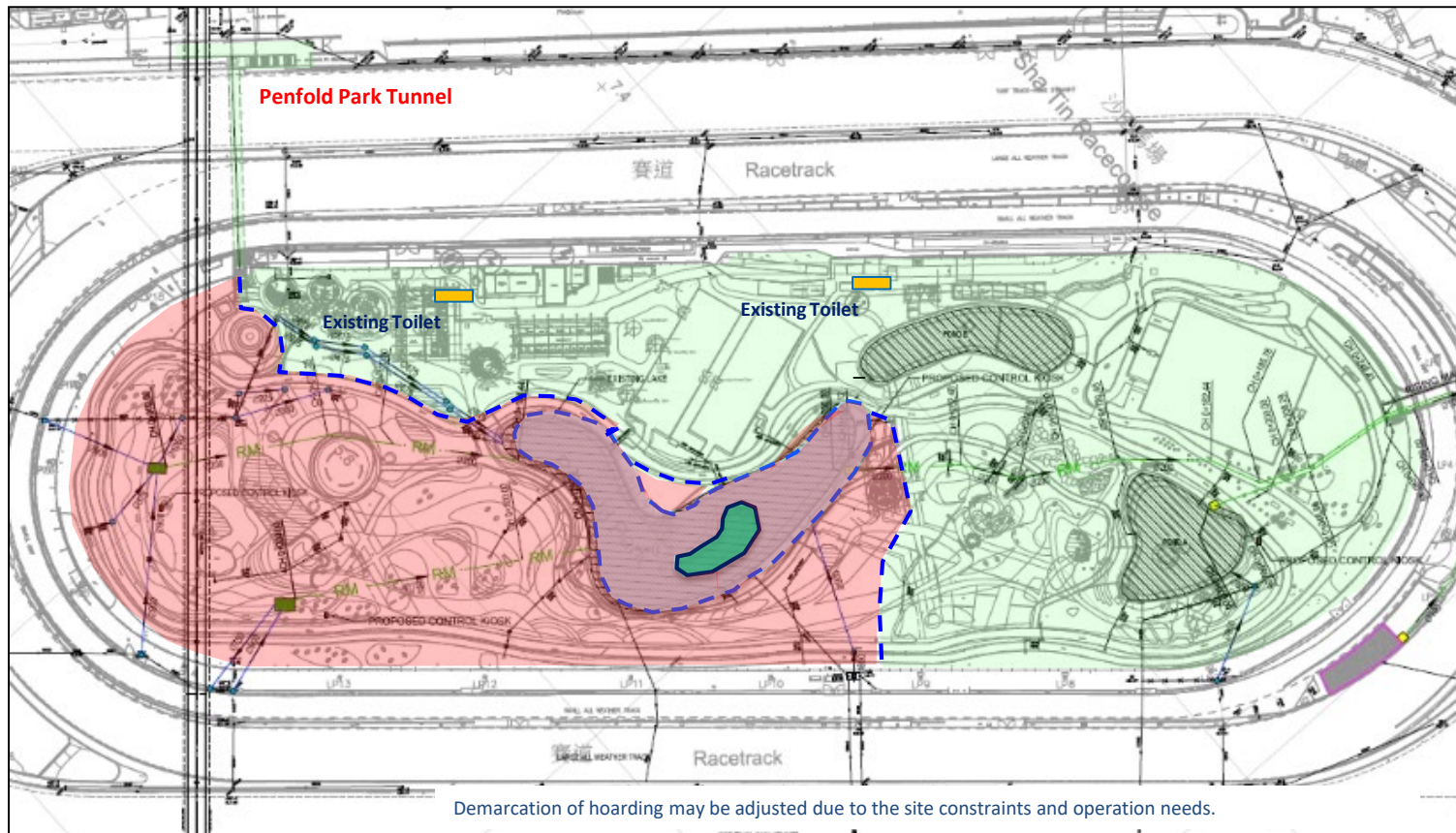

- Construction Area (No access to public)
- Open to Public
- Tree Island
- Hoarding with Corrugated Sheet

Demarcation of hoarding may be adjusted due to the site constraints and operation needs.

CONSTRUCTION PHASE 2 – JUN 2024 TO OCT 2025 (17 MONTHS)

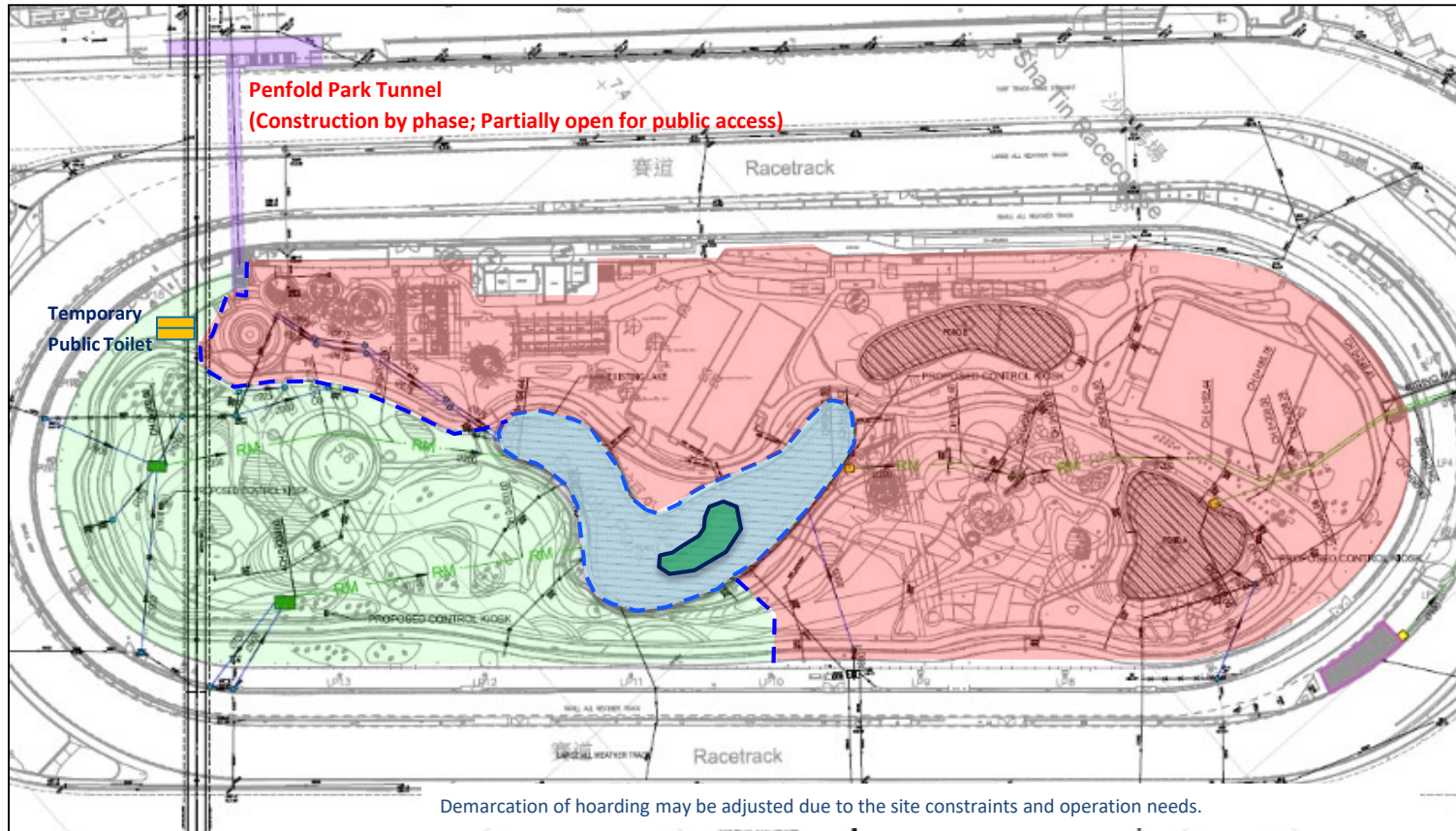

- Construction Area (No access to public)
- Open to Public
- Construction by phase (Partially open for public access)
- Tree Island
- Hoarding with Corrugated Sheet

Temporary Public Toilet

Penfold Park Tunnel
(Construction by phase; Partially open for public access)

Demarcation of hoarding may be adjusted due to the site constraints and operation needs.